

**CERTIFIED COPY OF ORDER**

STATE OF MISSOURI }  
 County of Boone } ea.

August Session of the July Adjourned Term. 20 05

In the County Commission of said county, on the 16<sup>th</sup> day of August 20 05

the following, among other proceedings, were had, viz:

Now on this day the County Commission of the County of Boone does hereby set the E911 tax levy at 2% of the tariff rate, the level at which it is currently maintained.

Done this 16<sup>th</sup> day of August, 2005.

ATTEST:

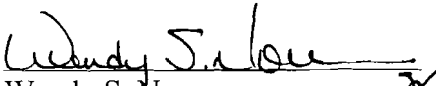
  
 Wendy S. Noren  
 Clerk of the County Commission

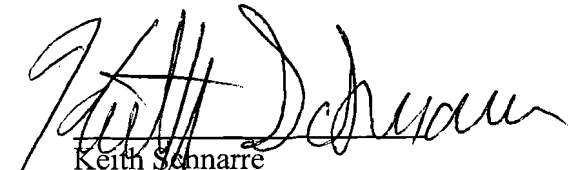
  
 Keith Sennarre  
 Presiding Commissioner

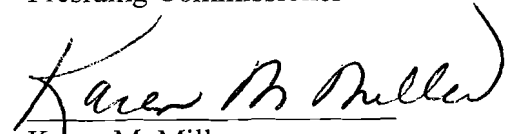
  
 Karen M. Miller  
 District I Commissioner

  
 Skip Elkin  
 District II Commissioner

# *Missouri Revised Statutes*

## Chapter 190 Emergency Services Section 190.310

August 28, 2004

---

### **Tax due quarterly--return filed when, content--record retention period--rate determination, notification--collection fee allowed.**

190.310. 1. The tax imposed by sections 190.300 to 190.320 and the amounts required to be collected are due quarterly. The amount of tax collected in one calendar quarter by the service supplier shall be remitted to the governing body no later than sixty days after the close of a calendar quarter. On or before the sixtieth day of each calendar quarter following, a return for the preceding quarter shall be filed with the governing body in such form as the governing body and service supplier shall agree. The service supplier will include the list of any service user refusing to pay the tax imposed by sections 190.300 to 190.320 with each return filing. The service supplier required to file the return shall deliver the return, together with a remittance of the amount of the tax collected under the provisions of sections 190.300 to 190.320. The records shall be maintained for a period of one year from the time the tax is collected.

2. From every remittance to the governing body made on or before the date when the same becomes due, the service supplier required to remit the same shall be entitled to deduct and retain, as a collection fee, an amount equal to two percent thereof.

3. At least once each calendar year, the governing body shall establish a tax rate, not to exceed the amount authorized, that together with any surplus revenues carried forward will produce sufficient revenues to fund the expenditures authorized by sections 190.300 to 190.320. Amounts collected in excess of that necessary within a given year shall be carried forward to subsequent years. The governing body shall make its determination of such tax rate each year no later than September first and shall fix the new rate which shall be collected as provided in sections 190.300 to 190.320. Immediately upon making its determination and fixing the rate, the governing body shall publish in its minutes the new rate, and it shall notify by mail every service supplier registered with it of the new rate. The governing body may require an audit of the service supplier's books and records concerning the collection and remittance of the tax authorized by sections 190.300 to 190.320.

(L. 1981 H.B. 437 § 3, A.L. 1990 H.B. 951)

Effective 6-12-90

---

# CERTIFIED COPY OF ORDER

STATE OF MISSOURI }  
County of Boone } ea.

August Session of the July Adjourned Term. 20 05

In the County Commission of said county, on the 16<sup>th</sup> day of August 20 05

the following, among other proceedings, were had, viz:

Now on this day the County Commission of the County of Boone does hereby approve the following budget amendment:

DEPARTMENT ACCOUNT AND TITLE	AMOUNT INCREASE
2540-91200: Sheriff's Civil Process Fund – Buildings/Improvement	\$3,500.00
2540-91200: Sheriff's Civil Process Fund – Buildings/Improvement	\$270.00

Said budget amendment is for a water hydrant and deck at the Sheriff's Department North Substation.

Done this 16<sup>th</sup> day of August, 2005.

  
Keith Schmarre  
Presiding Commissioner

ATTEST:

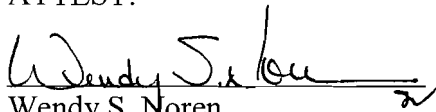
  
Wendy S. Noren  
Clerk of the County Commission

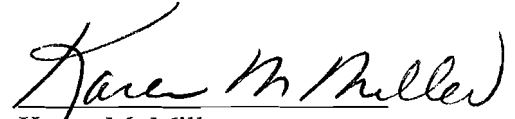
  
Karen M. Miller  
District I Commissioner

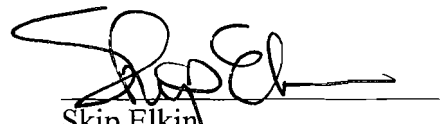
  
Skip Elkin  
District II Commissioner

1st 8/4  
2nd 8/16

# REQUEST FOR BUDGET AMENDMENT

## BOONE COUNTY, MISSOURI

RECEIVED

08-02-05

EFFECTIVE DATE

AUG 02 2005 FOR AUDITORS USE  
336-2005

Department				Account					Department Name	BOONE COUNTY AUDITOR'S ACCOUNT NAME	BOONE COUNTY AUDITOR'S (Use whole \$ amounts)	
											Decrease	Increase
2	5	4	0	9	1	2	0	0	CIVIL PROCESS FUNDS	BUILDINGS/IMPROVE		3500.00
2	5	4	0	9	1	2	0	0	"	"		270.00
										TOTAL		3770.00

Describe the circumstances requiring this Budget Amendment. Please address any budgetary impact for the remainder of this year and subsequent years. (Use attachment if necessary): LABOR FOR BUILDING A DECK AT THE NORTH SUBSTATION. THE MATERIALS WERE DONATED BY MIDCITY LUMBER. REQUESTING ADDITIONAL \$300.00 FOR ANY UNFORSEEN MATERIALS NEEDED.

*Plus \$270.00 for water hydrant at north substation*

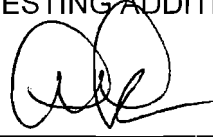

Requesting Official

*Nsubstation - deck & water hydrant*

**TO BE COMPLETED BY AUDITOR'S OFFICE**

- A schedule of previously processed Budget Revisions/Amendments is attached.
- A fund-solvency schedule is attached.
- Comments:

*Commission agenda*



*[Signature]*  
PRESIDING COMMISSIONER

*[Signature]*  
DISTRICT I COMMISSIONER

*[Signature]*  
DISTRICT II COMMISSIONER

**BUDGET AMENDMENT PROCEDURES**

- County Clerk schedules the Budget Amendment for a first reading on the commission agenda. A copy of the Budget Amendment and all attachments must be made available for public inspection and review for a period of at least 10 days commencing with the first reading of the Budget Amendment.
- At the first reading, the Commission sets the Public Hearing date (at least 10 days hence) and instructs the County Clerk to provide at least 5 days public notice of the Public Hearing. **NOTE: The 10-day period may not be waived.**
- The Budget Amendment may not be approved prior to the Public Hearing.

BOONE COUNTY SHERIFF'S DEPARTMENT  
NORTH SUBSTATION DECK BIDS

THE DECK PROJECT WAS SPLIT INTO TWO COMPONENTS- LABOR AND THE MATERIALS NEEDED.

IN MARCH 2005 I, GARY GERMAN, CONTACTED JENNY ATWELL. HER HUSBAND, CHARLES ATWELL, OWNS ATWELL'S HOME IMPROVEMENT AND BUILDS DECKS. I PROVIDED HER WITH THE DRAWING FOR THE FRONT DECK AND ADA RAMP. IT ALSO CONTAINED A SECTION ABOUT A SMALL DECK WITH JUST STAIRS FOR THE BACK DECK. I DID NOT RECEIVE A REPLY FROM CHARLES DURING THE MONTH OF MARCH. ON MARCH 31<sup>ST</sup> I ASKED JENNY ABOUT IT. ON APRIL 1<sup>ST</sup> JENNY CONTACTED ME AND ADVISED CHARLES WAS TOO BUSY TO DO IT. JENNY STATED CHARLES IS CURRENTLY DOING SEVERAL TILE PROJECTS AND DID NOT HAVE TIME TO DO IT.

I ALSO CONTACTED DEPUTY DERRICK DODSON IN APRIL OF 2005. DERRICK DOES CONSTRUCTION WORK ON THE SIDE AND ASKED IF HE KNEW OF ANYONE THAT BUILDS DECKS. DERRICK STATED HIS NEIGHBOR, ALAN MCCALLISTER (875-1316), BUILDS DECKS. I PROVIDED DERRICK WITH A COPY OF THE DRAWING FOR THE FRONT DECK, ADA RAMP AND BACK DECK SPECS. DERRICK INFORMED ME THAT ALAN SAID HE WAS TOO BUSY AND PROBABLY WOULDN'T BE ABLE TO GET IT DONE WHEN THE SHERIFF'S DEPARTMENT WANTED TO DO IT .

ON 3-31-05 I MET WITH RYAN BLAIR (808-3521) AND PROVIDED HIM WITH THE PROJECT PLANS. RYAN STATED HE NEEDED SOME TIME TO LOOK OVER IT AND GET BACK TO ME. RYAN STATED HE HAD NEVER BUILT AN ADA RAMP AND WOULD NEED TO LOOK INTO IT. THE NEXT WEEK I MET WITH RYAN AGAIN. RYAN QUOTED TO ME THAT THE LABOR FOR THE FRONT DECK PLATFORM WOULD BE \$400 AND THE LABOR FOR THE STAIRS WAS GOING TO BE \$300. RYAN STATED HE DID NOT HAVE ANY IDEA HOW TO BUILD THE ADA RAMP AND AGAIN STATED HE HAD NEVER BUILT ONE AND DID NOT KNOW HOW TO QUOTE ME A PRICE ON IT. RYAN STATED HE DID NOT FEEL COMFORTABLE GIVING ME A PRICE FOR THE ADA RAMP.

I THEN CONTACTED QUALITY PROFESSIONAL CONSTRUCTION (819-3262) AND SPOKE TO RAY GREENING. RAY ADVISED HE HAD BUILT ADA RAMPs FOR COLUMBIA PUBLIC SCHOOLS AND THE UNIVERSITY OF MISSOURI. I MET RAY AT THE NORTH SUBSTATION ON MAY 26, 2005. I GAVE RAY A COPY OF THE DECK PLANS. RAY SUGGESTED MOVING THE RAMP TO THE OTHER SIDE OF THE DECK, SO IT WOULD LOOK BETTER. RAY STATED HE WOULD LOOK OVER THE PLANS AND GIVE ME A BID. ON 7-15-05 I MET WITH RAY AND OBTAINED A BID FOR THE LUMBER AND MATERIALS. RAY'S BID FOR THE LABOR WAS \$3155.00.

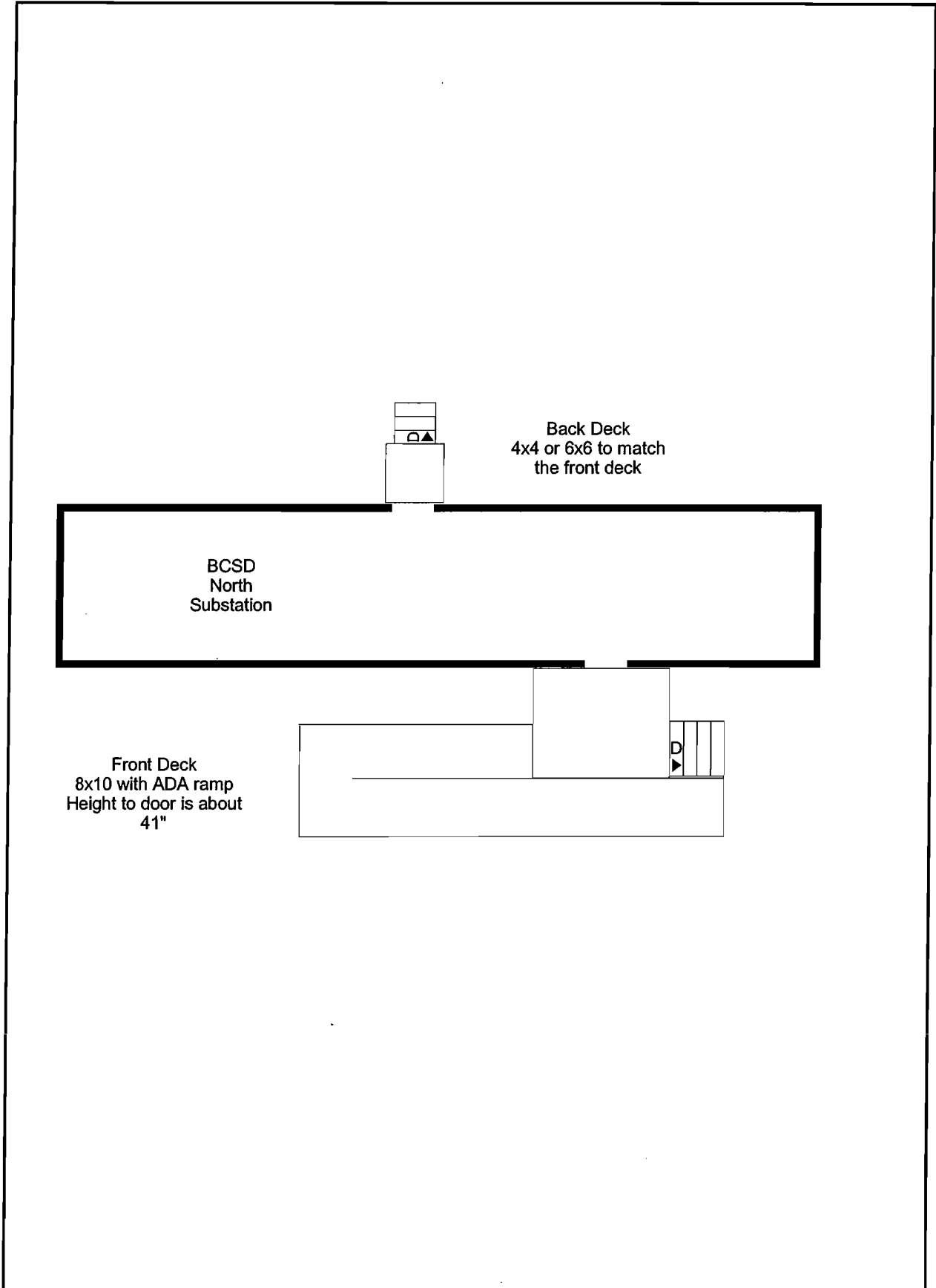

Back Deck  
4x4 or 6x6 to match  
the front deck

BCSD  
North  
Substation

Front Deck  
8x10 with ADA ramp  
Height to door is about  
41"

D

Looking at using  
5/4" treated decking

Gary German  
Cell phone 228-4030 or 875-1111  
Call if you have questions  
Office  
Trailer

It is free standing  
& not attached  
to the trailer

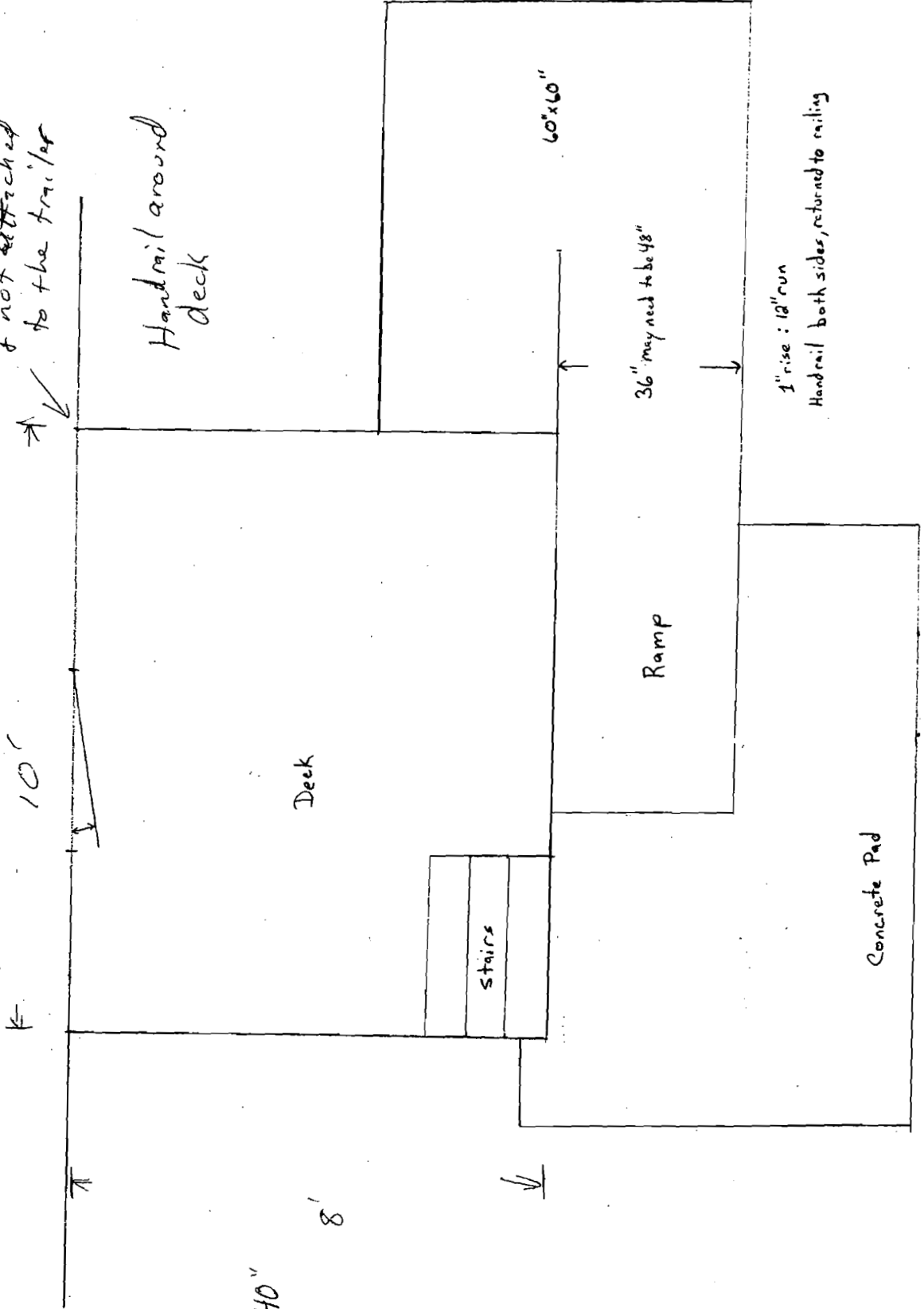

The height  
is about ~~39~~ 1/4" to 40"  
off the ground.

This is to the  
door sill.

3rd this separate  
in Additional Item

set of stairs  
wide to 4'x4'  
(platform)  
but goes up  
to the door (back)  
ie height to  
a door sill  
32"



P.O. Box 8165  
Springfield, MO 65801  
417-882-3254

Roof Top Delivery Specialists

DECK - 2x8 JOIST - 16" O.C.  
8x10 5/4 A.C.Q FLOORING. 6x6 POST +  
DECK RAILS 2x10 BEAMS  
4x4 POST - CEDAR  
26" DECKORATORS 4 1/2" O.C.  
2x6 TOP CAP CEDAR  
RAMP - 2x12 JOIST  
5/4 A.C.Q FLOORING  
CEDAR RAILS + DECKORATORS TO  
MATCH DECKS

LABOR ~~MATERIAL \$650.00~~  
3155

BACK DECK TO MATCH FRONT

6x6 →

(417) 865-4266 • Springfield, MO (573) 474-4880 • Columbia, MO  
(417) 623-1234 • Joplin, MO (316) 838-7408 • Wichita, KS  
(816) 333-7889 • Kansas City, MO (660) 438-5991 • Warsaw, MO



**BOONE COUNTY SHERIFF'S DEPARTMENT**

**INTER-OFFICE COMMUNICATION**

**TO:** Sheriff Carey  
**FROM:** Capt. German  
**DATE:** 08/01/05 5:49 PM  
**SUBJECT:** North Substation deck

Sheriff Carey,

I requested bids on building decks for the Sheriff's Department North Substation. I contacted Atwell's Home Improvement, Ryan Blair and Quality Professional Construction. In addition, Deputy Derrick Dodson contacted Alan McCallister. This included providing them with the plan for the decks.

On 4-1-05 I was advised that Charles Atwell of Atwell's Home Improvement was too busy to do the job and was currently doing tile work. Ryan Blair advised he would bid the labor on the project. Prior to finding out that the project had to be bid at prevailing wage, Blair stated the platform would be \$400 and the stairs \$300. However, Blair then advised he had no idea how to build the ADA ramp and could not give me a figure for it. I consider Blair's bid to be incomplete due to him not knowing how to build the ADA ramp. Deputy Dodson stated McCallister told him that he was too busy.

I then learned that Ray Greening with Quality Professional Construction used to build the ADA ramps for Columbia Public Schools. Mr. Greening submitted a bid for the labor for \$3155.00. This bid reflects prevailing wage.

I also secured bids for the lumber for the decks. I requested bids from Meeks, LaCrosse and Mid-City. Meeks bid the materials at \$4173.70. LaCrosse bid the materials at \$3988.84. Quality Professional Construction bid the materials at \$3543.00. I received a call from Mike Dodson from Mid-City. Mike stated the bid package he had came in around \$4500. Mike stated he would like to donate the materials for the project. I told Mike I would have to check into it and get back with him. Mike stated he also needed to talk to Mike Teel.

I checked with Heather Turner in Purchasing. Heather did not think there would be a problem with accepting donation. Heather stated she would check with John Patton and let me know. Heather left me a message stating Patton did not think there would be a problem with it. Heather stated Mid-City would probably request some sort of recognition for the donation for tax purposes.

Please let me know if you have any questions.

Sincerely,

A handwritten signature in cursive script, appearing to read "Capt. Gary German", followed by a long horizontal flourish.

Capt. Gary German



**Fund 254: Sheriff Civil Charges Fund**  
**Solvency Analysis**  
**Prepared by Auditor's Office**  
**8-2-2005**

Fund Balance (Unreserved) 1-1-2005 (Account 2913) 13,070.24

Plus: Actual Revenues 2005  
 Charges for Services 50,000.00

Less: Budgeted Expenditures 2005

	Current Budget	Budget Revision/ Amendment	Total	Actual YTD Expenditures + Encumbrances	Remaining Budget
Class 1	0.00	0.00	0.00	0.00	0.00
Class 2	400.00	0.00	400.00	0.00	400.00
Class 3	0.00	0.00	0.00	0.00	0.00
Class 4	6,770.00	0.00	6,770.00	1,051.89	5,718.11
Class 5	0.00	0.00	0.00	0.00	0.00
Class 6	0.00	0.00	0.00	0.00	0.00
Class 7	4,400.00	0.00	4,400.00	1,862.90	2,537.10
Class 8	0.00	0.00	0.00	0.00	0.00
Class 9	3,000.00	3,770.00	6,770.00	2,812.00	3,958.00
	<u>14,570.00</u>	<u>3,770.00</u>	<u>6,770.00</u>	<u>5,726.79</u>	<u>12,613.21</u>

(18,340.00)

Anticipated Fund Balance 12-31-2005

44,730.24

2005 CLASS 9

Dept-Account	Description	Original Budget Amount	Budget Revision Date	Budget Revision Amount	Revised Budget	Encumbrance Date	Encumbrance Amount	Payment Date	Payment Amount	Unused Budget
<b>Sheriff Civil Charges</b>										
2540-91100	Budget Amendment		2-9-2005	3,000	3,000			3-9-2005	2,552	3,000
2540-91100	workstation panels ( added 3-9-2005)	0		3,000	3,000		0		2,552	(2,552)
	<b>Total</b>									448
2540-91200	electric service hook-up to mobile substation (added 4-27-2005)		8-2-2005	3,770	3,770			4-27-2005	260	(260)
2540-91200	Budget Amendment for deck (\$3500) & water hydrant (\$270)			3,770	3,770		0		260	3,770
2540-91200	deck (added 8-2-2005)	0		3,770	3,770		0		260	0
2540-91200	water hydrant ( added 8-2-2005)	0		6,770	6,770		0		2,812	3,958
	<b>Total</b>									
	<b>Total Sheriff Civil Charges</b>									

8/2/2005

FY 2005  
Budget Amendments/Revisions  
**Sheriff Civil Charges (2540)**

<u>Index #</u>	<u>Date Recd</u>	<u>Account</u>	<u>Account Name</u>	<u>\$Increase</u>	<u>\$Decrease</u>	<u>Reason/Justification</u>
1	1/11/2005	91100	Furniture & Fixtures	3,000		Additional workstation in conference area
2	1/21/2005	48000	Telephones		400	Annual internet service for substation
		71100	Outside Services	400		
3	3/9/2005	71100	Outside Services	3,000		Personnel testing
4	8/2/2005	91200	<b>Buildings &amp; Improvements</b>	<b>3,770</b>		<b>North substation deck and water hydrant</b>

**CERTIFIED COPY OF ORDER**

STATE OF MISSOURI }  
 County of Boone } ea.

August Session of the July Adjourned Term. 20 05

In the County Commission of said county, on the 16<sup>th</sup> day of August 20 05

the following, among other proceedings, were had, viz:

Now on this day the County Commission of the County of Boone does hereby approve the following appointments:

NAME (TOWNSHIP)	BOARD/COMMISSION	TERM EXPIRATION
Deborah K. Schnedler (Cedar)	Boone County Regional Sewer District Board of Trustees	August 31, 2010 (re-appointment)
Jessica Robinson (Rock Bridge)	Boone County Library Board	July 1, 2009
James D. Schepers (Columbia)	Industrial Development Authority	August 31, 2011 (re-appointment)
J. Scott Christianson (Missouri)	Industrial Development Authority	August 31, 2011
Nathan D. Voris (Three Creeks)	Board of Health	August 31, 2008
Jerry C. Olson (Columbia)	Building Code Commission	May 2, 2006 (interim)

Done this 16<sup>th</sup> day of August, 2005.

ATTEST:

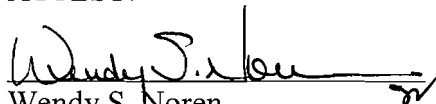
  
 Wendy S. Noren  
 Clerk of the County Commission

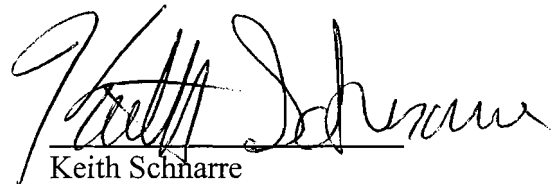
  
 Keith Schnarre  
 Presiding Commissioner

  
 Karen M. Miller  
 District I Commissioner

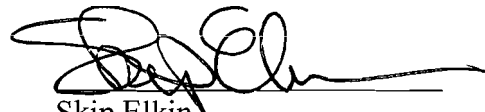
  
 Skip Elkin  
 District II Commissioner





Keith Schnarre, Presiding Commissioner  
Karen, M. Miller, District I Commissioner  
Skip Elkin, District II Commissioner



Boone County Government Center  
801 E. Walnut, Room 245  
Columbia, MO 65201  
573-886-4305 • FAX 573-886-4311  
E-mail: commission@boonecountymo.org

# Boone County Commission

*Appoint - 4yr Term - Aug 16, 2005 - July 31, 2009*

## BOONE COUNTY BOARD OR COMMISSION APPLICATION FORM

Board or Commission: Library Board Term: 7/18/2005

Current Township: Rock Bridge Today's Date: 7/18/2005

Name: Jessica Robinson

Home Address: 262 E. High Point Lane Zip Code: 65203

Business Address: \_\_\_\_\_ Zip Code: \_\_\_\_\_

Home Phone: 573-875-3024 Work Phone: \_\_\_\_\_  
Fax: \_\_\_\_\_ E-mail: jay\_and\_jess@hotmail.com

Qualifications: former member Daniel Boone Regional Library Board of Trustees, Columbia  
Public Library Board of Trustees  
two years collective library staff experience

Past Community Service: City/County Stormwater Taskforce  
Missouri Stream Team  
MS 150 Volunteer and Participant  
KC Children's Hospital Groundhog Run  
Columbia Chamber of Commerce Committee Member

References: Tif Laufer - 175 E. State Rd. M  
Hartsburg, MO 65039  
(573) 657-4879 (H)  
(573) 499-6767 (W)  
Bertrice Bartlet -  
1627 Wilson Ave.  
Columbia, MO 65201  
(573) 442-5549 (H)

I have no objections to the information in this application being made public. To the best of my knowledge at this time I can serve a full term if appointed. I do hereby certify that the above information is true and accurate.

Applicant Signature

Return Application To: Boone County Commission Office  
Boone County Government Center  
801 East Walnut, Room 245  
Columbia, MO 65201  
Fax: 573-886-4311

~~INTERVIEWS:~~  
9:00 -  
8:45 - SE  
8:30 -

1444 1 1 20

Keith Schnarre, Presiding Commissioner  
Karen M. Miller, District I Commissioner  
Skip Elkin District II Commissioner



Boone County Government Center  
801 E. Walnut, Room 245  
Columbia, MO 65201  
573-886-4305 • FAX 573-886-4311  
E-mail: commission@boonecountymo.org

RECEIVED

JUL - 5 2005

# Boone County Commission

Boone County Commission Reappoint - by term: 8/31/2005 - 8/31/2011

## BOONE COUNTY BOARD OR COMMISSION APPLICATION FORM

Board or Commission: Industrial Development Authority Term: \_\_\_\_\_

Current Township: Columbia Today's Date: 7-1-05

Name: James (Jim) D. Schepers

Home Address: 4009 Beach Pointe Dr. Col. MO Zip Code: 65203

Business Address: 1817 W. Broadway Col. MO Zip Code: 65218

Home Phone: 445-3587

Work Phone: 214-4877

Fax: \_\_\_\_\_

E-mail: JSchepers@Shelterinsurance.com

Qualifications: Have completed 2 terms on the board. Served as its Treasurer for 8 years.

Past Community Service: Community Development Commission - Currently, Personnel Advisory Board - City - Current  
President - Columbia Jaycees, Katy Lake Home Owners Assoc.  
Other service

References: Joe Moseley, Don Stamper, Bob Bailey

I have no objections to the information in this application being made public. To the best of my knowledge at this time I can serve a full term if appointed. I do hereby certify that the above information is true and accurate.

Applicant  
Signature

Return Application To: **Boone County Commission Office  
Boone County Government Center  
801 East Walnut, Room 245  
Columbia, MO 65201  
Fax: 573-886-4311**

*Interview not necessary  
by 3C*

Keith Schnarre, Presiding Commissioner  
Karen, M. Miller, District I Commissioner  
Skip Elkin, District II Commissioner



Boone County Government Center  
801 E. Walnut, Room 245  
Columbia, MO 65201  
573-886-4305 • FAX 573-886-4311  
E-mail: commission@boonecountymo.org

# Boone County Commission

*Appx 6 yr term Aug 31, 2005 - Aug 31, 2011*

## BOONE COUNTY BOARD OR COMMISSION APPLICATION FORM

Board or Commission: Industrial Development Authority Term: 7/10/2005

Current Township: Missouri Today's Date: 7/10/2005

Name: J. Scott Christianson

Home Address: 300 South Garth Ave Zip Code: 65203

Business Address: Kaleidoscope Consulting 201 West Broadway, Building 3 Suite H Zip Code: 65203

Home Phone: 573-442-0803 Work Phone: 573-424-4254  
Fax: 888-423-5225 E-mail: jsc@kalvideo.com

Qualifications: \* Local business owner, involved with Columbia Chamber of Commerce and Missouri Chamber of Commerce.  
\* Interested in economic development and maintaining a healthy diversity of local businesses and industry.  
\* Interested in learning more about local government by providing service on a local board or commission.

Past Community Service: \*Co-Chair, Vocational Service Committee, Metro Rotary, 2005-present (Appointed by Rotary President).  
\*Member, Internet Citizens Advisory Group, City of Columbia, 2003-present (Appointed by Columbia City Council).  
\*Member, Missouri Digital Government Summit Advisory Board, 2005.  
\*Member, Governmental Affairs Committee, Columbia Chamber of Commerce, 2003-present.  
\*Member, Missouri Rural Opportunities Council, Education and Telecommunications Committee, 2002-2005.

References: Don Laird  
President  
Columbia Chamber of Commerce  
PO Box 1046  
Columbia, MO 65202  
Office Phone: (573) 874-1132  
Email: dlaird@chamber.columbia.mo.us  
Mike Christy  
Director Crosby MBA Program  
School of Business  
211 Central Hall

I have no objections to the information in this application being made public. To the best of my knowledge at this time I can serve a full term if appointed. I do hereby certify that the above information is true and accurate.

Applicant Signature

Return Application To: Boone County Commission Office  
Boone County Government Center  
801 East Walnut, Room 245  
Columbia, MO 65201  
Fax: 573-886-4311

*L.M. 7-11*

*Wend, July 27*  
*9- KS*  
*9:15 Rmm*  
*9:30 SE*

Keith Schnarre, Presiding Commissioner  
Karen, M. Miller, District I Commissioner  
Skip Elkin, District II Commissioner



Boone County Government Center  
801 E. Walnut, Room 245  
Columbia, MO 65201  
573-886-4305 • FAX 573-886-4311  
E-mail: commission@boonecountymo.org

# Boone County Commission

*Appt - 3yr Term Expires 8/31/2008*

## BOONE COUNTY BOARD OR COMMISSION APPLICATION FORM

Board or Commission: Board of Health Term: 7/22/2005

Current Township: Three Creeks Today's Date: 7/22/2005

Name: Nathan D. Voris

Home Address: 10610 E. David Allen Rd Zip Code: 65201

Business Address: 5851 Deer Park Rd Zip Code: 65201

Home Phone: 573-441-9714 Work Phone: 573-443-4414  
Fax: 573-441-9784 E-mail: vorisn@hotmail.com

Qualifications: Veterinarian (DVM from MU-1999, associate at Equine Medical Services  
2000-current), MBA (William Woods-2004), Member of Agricultural  
Leadership of Tomorrow Class XI (2005-06).

Past Community Service: Non-faculty advisor to the MU Vet Med Equine Club (2004-  
current), Advisory Board member for MU College of Agriculture  
Horse Farm (2005)

References: Frank Glenn, Rob Foss, John Dodam

I have no objections to the information in this application being made public. To the best of my knowledge at this time I can serve a full term if appointed. I do hereby certify that the above information is true and accurate.

Applicant Signature

Return Application To: Boone County Commission Office  
Boone County Government Center  
801 East Walnut, Room 245  
Columbia, MO 65201  
Fax: 573-886-4311

*L.M. 7-27 Wed 8/3*  
*INTERVIEWS:*  
*11:00 - SE*  
*11:15 - Kman*  
*11:30 - RS*

Keith Schnarre, Presiding Commissioner  
Karen, M. Miller, District I Commissioner  
Skip Elkin, District II Commissioner



Boone County Government Center  
801 E. Walnut, Room 245  
Columbia, MO 65201  
573-886-4305 • FAX 573-886-4311  
E-mail: commission@boonecountymo.org

# Boone County Commission

*Interim Appt - Expires 5/02/2006*

## BOONE COUNTY BOARD OR COMMISSION APPLICATION FORM

Board or Commission: Building Code Commission Term: 7/11/2005

Current Township: Columbia Today's Date: 7/11/2005

Name: Jerry C Olson

Home Address: 3711 Shadow Glen Ct Zip Code: 65203

Business Address: Retired Zip Code: \_\_\_\_\_

Home Phone: 573 823 5250 Work Phone: \_\_\_\_\_  
Fax: \_\_\_\_\_ E-mail: jolson23@centurytel.net

Qualifications: College graduate, 15 years as Director Commercial Operation, Cal State Fullerton (Titan Shops)

Past Community Service: Drug and Alcohol commission for the Episcopal Church

References: Mr. Robert Pugh, CEO, MBS

I have no objections to the information in this application being made public. To the best of my knowledge at this time I can serve a full term if appointed. I do hereby certify that the above information is true and accurate.

\_\_\_\_\_  
Applicant Signature

Return Application To: Boone County Commission Office  
Boone County Government Center  
801 East Walnut, Room 245  
Columbia, MO 65201  
Fax: 573-886-4311

*July 25*  
*✓ 8:00 - SE*  
*✓ 8:15 - RMM*  
*1:00 - VC*

**CERTIFIED COPY OF ORDER**

STATE OF MISSOURI }  
 County of Boone } ea.

August Session of the July Adjourned Term. 20 05

In the County Commission of said county, on the 16<sup>th</sup> day of August 20 05

the following, among other proceedings, were had, viz:

Now on this day the County Commission of the County of Boone does hereby approve the use of the Courtyard Square on September 30, 2005 from 5:00 to 11:00 p.m. for an Arts Showcase sponsored by Leswood Ministries. It is further ordered that the Presiding Commissioner be hereby authorized to sign said application.

Done this 16<sup>th</sup> day of August, 2005.

ATTEST:

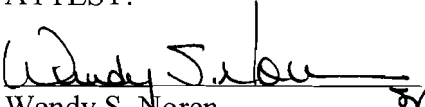
  
 Wendy S. Noren  
 Clerk of the County Commission

  
 Keith Schnarre  
 Presiding Commissioner

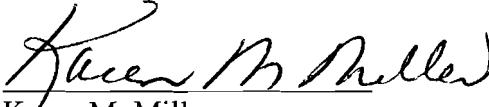
  
 Karen M. Miller  
 District I Commissioner

  
 Skip Elkin  
 District II Commissioner

Keith Schnarre, Presiding Commissioner  
Karen M. Miller, District I Commissioner  
S. Elkin, District II Commissioner



Roger B. Wilson  
Boone County Government Center  
801 East Walnut Room 245  
Columbia, MO 65201-7732  
573-886-4305 • FAX 573-886-4311

# Boone County Commission

338-7005

## APPLICATION FOR ORGANIZATIONAL USE OF BOONE COUNTY FACILITIES

The undersigned organization hereby applies for a permit to use the Boone County Courthouse Grounds and/or Government Center as follows:

Description of Use: Arts Showcase [Speakers, singers, etc]

Date(s) of Use: September 30<sup>th</sup> 2005

Time of Use: From: 5:00 a.m./p.m. thru 11:00 a.m./p.m.

Facility requested: Courthouse Grounds  - Courtyard Square  - Chambers  - Chambers Atrium  -  
Rm220  - Rm208  - Rm139

The undersigned organization agrees to abide by the following terms and conditions in the event this application is approved:

1. To notify the Columbia Police Department and Boone County Sheriff's Department of time and date of use and abide by all applicable laws, ordinances and county policies in using Courthouse grounds or designated rooms.
2. To remove all trash or other debris that may be deposited (by participants) on the courthouse grounds and/or in rooms by the organizational use.
3. To repair, replace, or pay for the repair or replacement of damaged property including shrubs, flowers or other landscape caused by participants in the organizational use of courthouse grounds and/or carpet and furnishings in rooms.
4. To conduct its use of courthouse grounds and/or rooms in such a manner as to not unreasonably interfere with normal courthouse and/or Boone County Government building functions.
5. To indemnify and hold the County of Boone, its officers, agents and employees, harmless from any and all claims, demands, damages, actions, causes of action or suits of any kind or nature including costs, litigation expenses, attorney fees, judgments, settlements on account of bodily injury or property damage incurred by anyone participating in or attending the organizational use on the courthouse grounds and/or use of rooms as specified in this application.

Name of Organization/Person: Leswood Ministries

Organization Representative/Title: Karita McDowell / Executive Assistant

Address/Phone Number: P.O. Box 85 Columbia, MO 65205 / 573-248-3357

Date of Application: Aug 11, 2005

### PERMIT FOR ORGANIZATIONAL USE OF BOONE COUNTY FACILITIES

The County of Boone hereby grants the above application for permit in accordance with the terms and conditions above written. The above permit is subject to termination for any reason by duly entered order of the Boone County Commission.

ATTEST:

BOONE COUNTY, MISSOURI

Wendy Silbo  
County Clerk

Keith Schnarre  
County Commissioner

DATE: 16 AUG 2005